

RevNo	Revision note	Date	Signature	Checked
	GENERAL REVISION		IP	IP

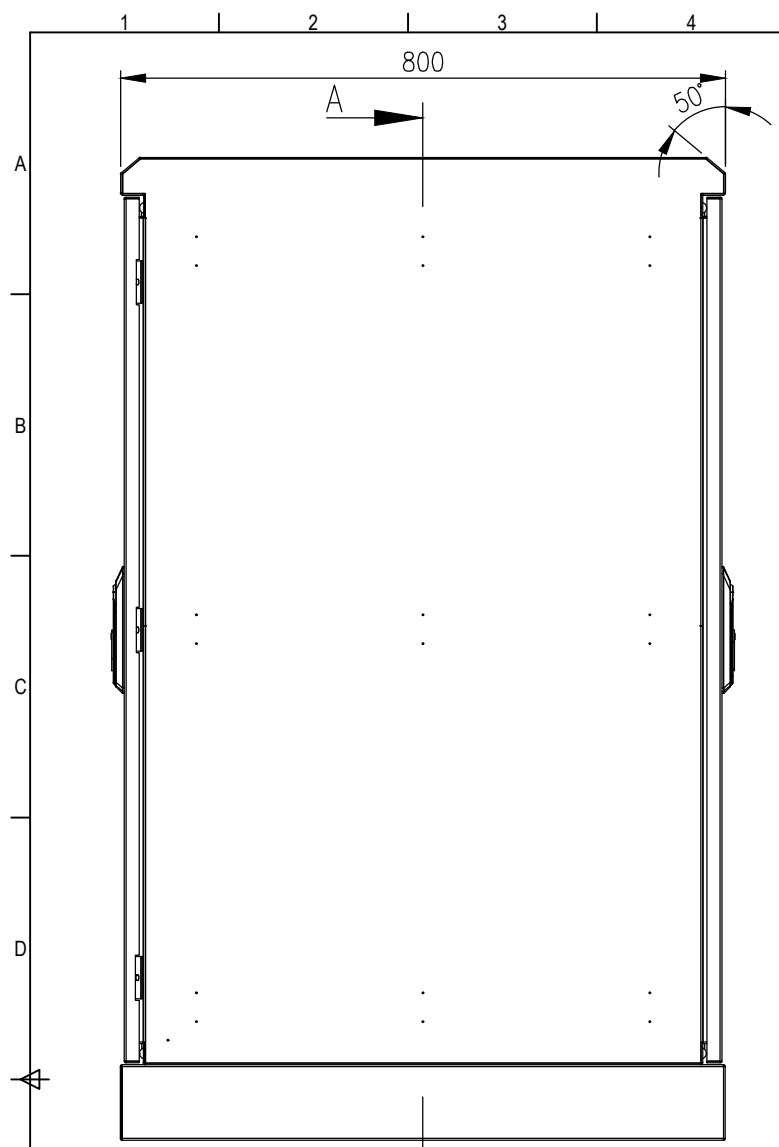

SIDE VIEW

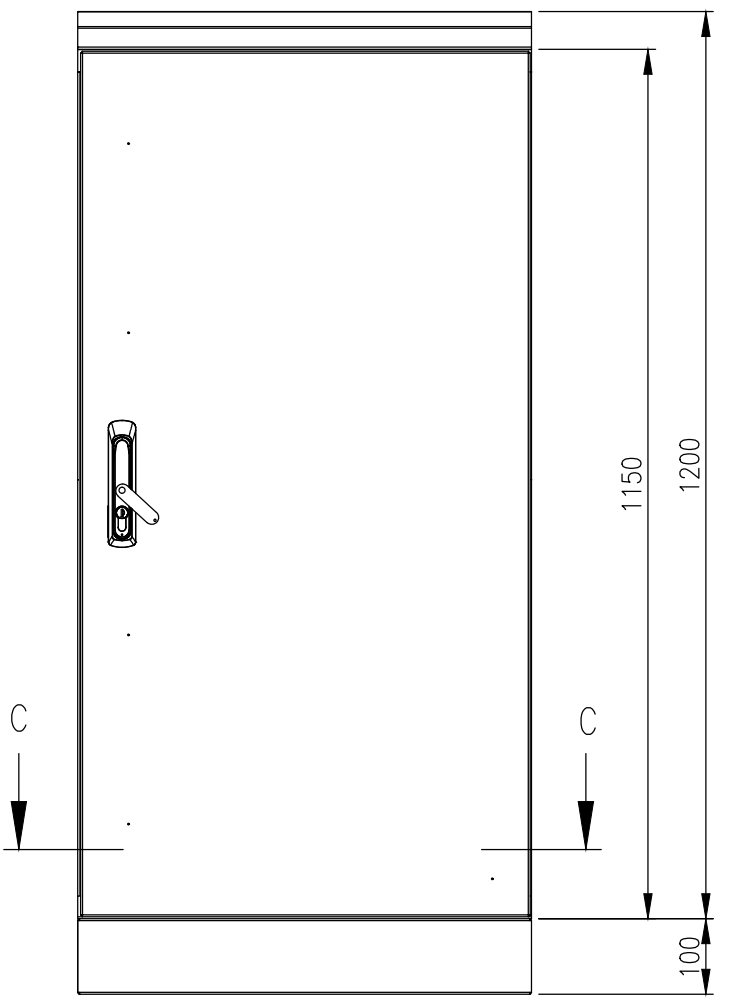

FRONT VIEW

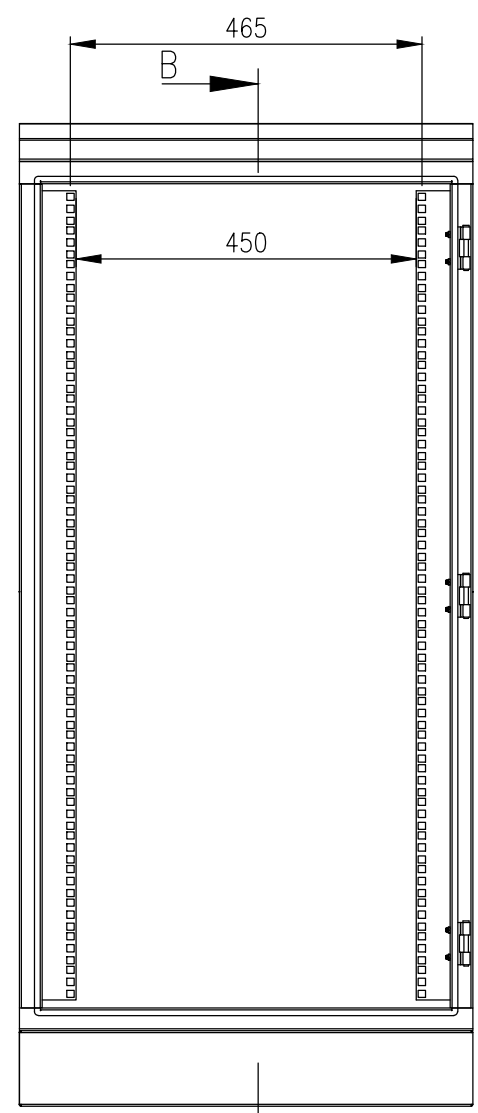

SECTION A-A

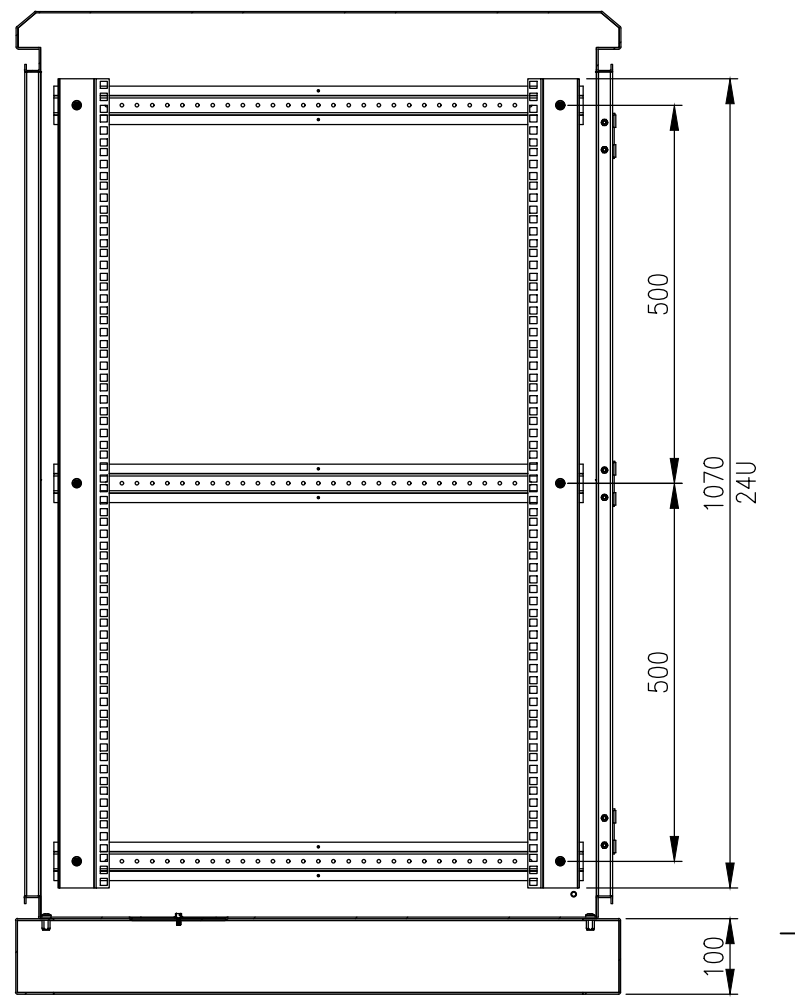

SECTION B-B

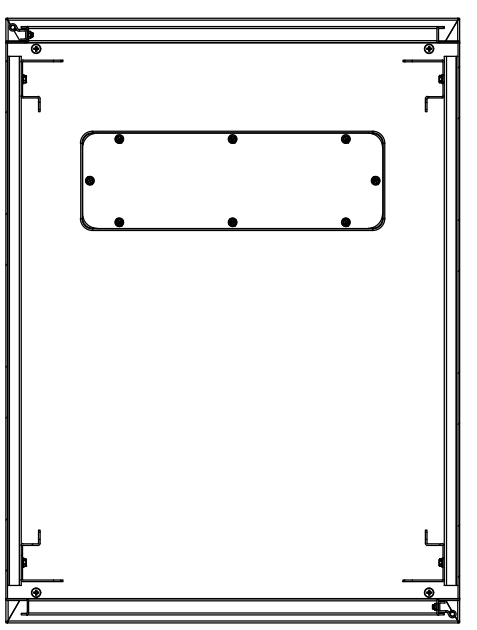

SECTION C-C

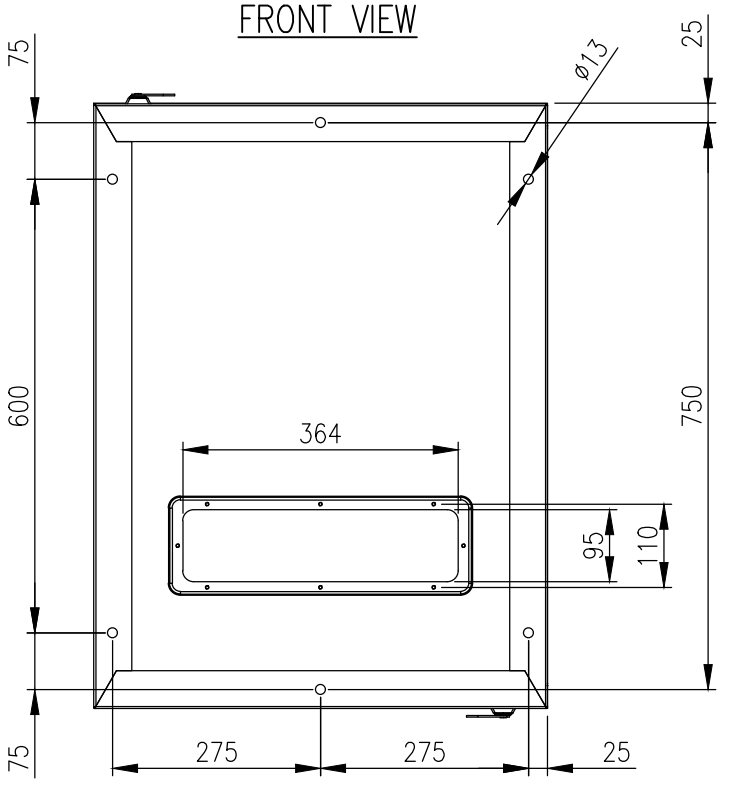

BOTTOM VIEW

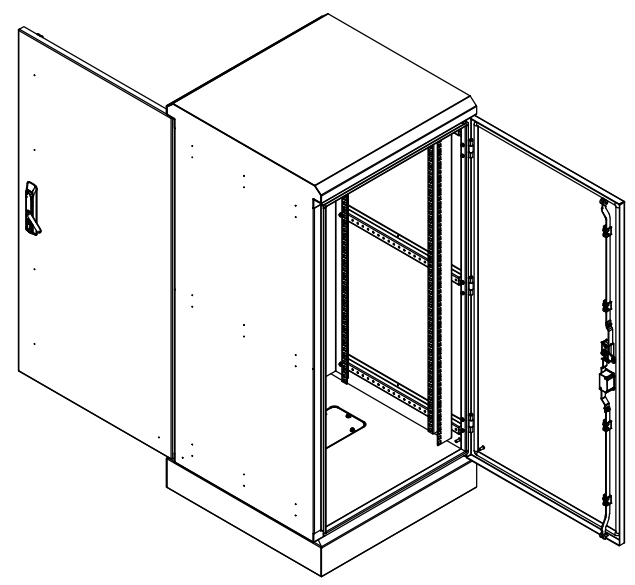

**MATERIAL**  
 BODY: 2.0mm GALVANISED STEEL SHEET  
 DOOR: 2.0mm GALVANISED STEEL SHEET  
 19" DATA RAILS: 1.5mm GALVANISED STEEL SHEET  
 SEAL: POLYURETHANE  
 SURFACE TREATMENT: POWDER-COAT 80-120micron  
 COLOUR: RAL7035 LIGHT GREY

MASS: 83Kg.

PROTECTION: IP66 IK10  
 STANDARD: IEC/EN/AS60529, IEC/EN62208, EIA-310-D

© IP ENCLOSURES 2025.  
 THIS DRAWING SHALL NOT BE COPIED OR REPRODUCED  
 WITHOUT AUTHORISATION FROM IP ENCLOSURES.  
 www.ipenclosures.com.au

Itemref	Quantity	Title/Name, designation, material, dimension etc	Article No./Reference
IP	1	24U 1200x600x800 IP66 19" DATA RACK	IP-SD1206080-RD
IP	1	IP-SD1206080-RD	IP-SD1206080-RD



24U 1200x600x800 IP66 19" DATA RACK  
 IP-SD1206080-RD  
 Edition 0  
 Sheet 1/1