

RevNo	Revision note	Date	Signature	Checked
0	GENERAL REVISION		IP	IP

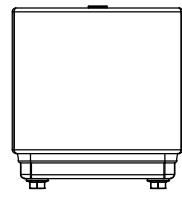

TOP VIEW

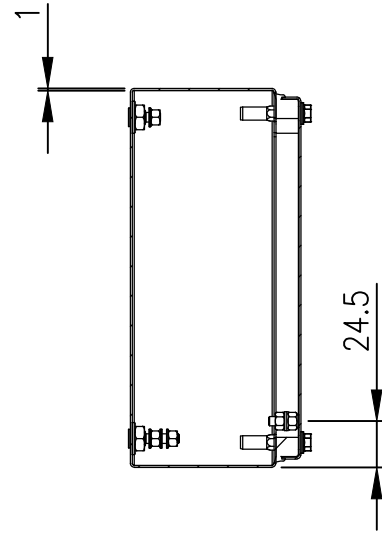
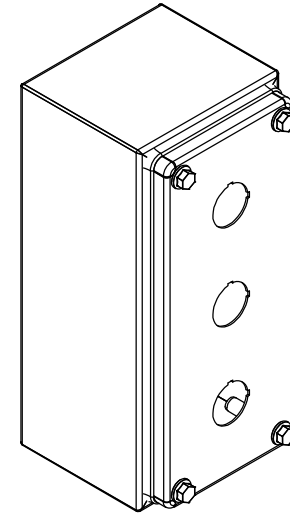

SECTION B-B

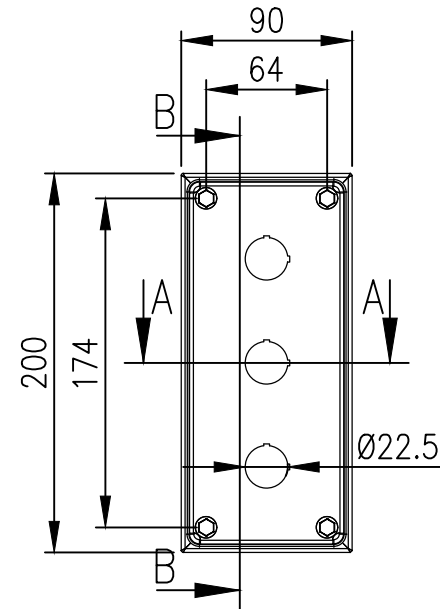

FRONT VIEW

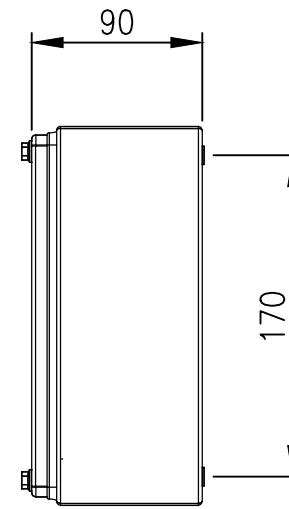

RIGHT SIDE VIEW

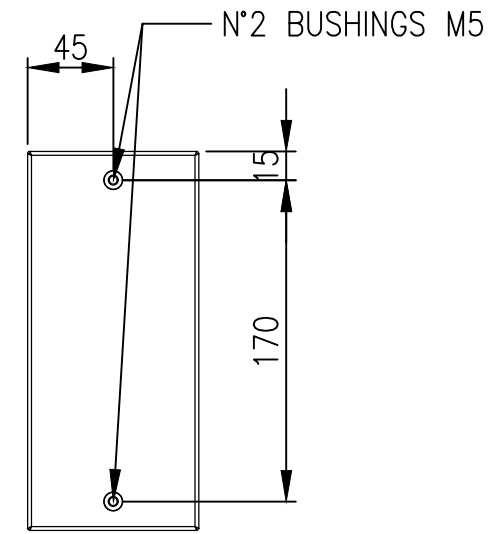

REAR VIEW

M5x15 THREADED BOLT

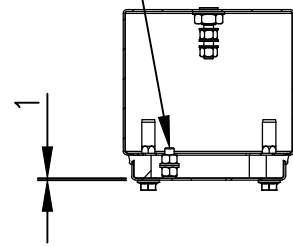

BOTTOM VIEW

**MATERIAL**

BODY: 1.0mm 304 STAINLESS STEEL  
COVER: 1.0mm 304 STAINLESS STEEL  
SEAL: BLUE SILICONE

**PROTECTION:** IP66 IK08, IP69K,  
NEMA TYPE 1, 12, 4, 4x

© IP ENCLOSURES 2023.  
THIS DRAWING SHALL NOT BE COPIED OR REPRODUCED  
WITHOUT AUTHORISATION FROM IP ENCLOSURES.  
www.ipenclosures.com.au

Itemref	Quantity	Title/Name, designation, material, dimension etc		Article No./Reference	
Designed by IP	Checked by IP	Approved by - date 21/03/23	Filename IP-HPB3	Date 21/03/23	Scale 1:4
			200x90x90 304SS PUSHBUTTON ENCLOSURE		
			IP-HPB3		Edition 0
					Sheet 1/1